

# BUILDING-STRUCTURE INVENTORY FORM

DIVISION FOR HISTORIC PRESERVATION  
NEW YORK STATE PARKS AND RECREATION  
ALBANY, NEW YORK (518) 474-0479

FOR OFFICE USE ONLY

UNIQUE SITE NO. 001-06-0135  
QUAD \_\_\_\_\_  
SERIES \_\_\_\_\_  
NEG. NO. \_\_\_\_\_

YOUR NAME: Town of Guilderland DATE: June 1, 1979

YOUR ADDRESS: Town Hall, Guilderland TELEPHONE: 518-356-1980  
N.Y.

ORGANIZATION (if any): \_\_\_\_\_

\*\*\*\*\*

## IDENTIFICATION

1. BUILDING NAME(S): McNiven Farm Complex (Building #27)  
2. COUNTY: Albany TOWN/CITY: Guilderland VILLAGE: \_\_\_\_\_  
3. STREET LOCATION: 4178 Altamont Rd.  
4. OWNERSHIP: a. public ☐ b. private ☒  
5. PRESENT OWNER: Roy McNiven ADDRESS: 4178 Altamont Rd., Altamont, N.Y.  
6. USE: Original: Farmhouse Present: Farmhouse 12009  
7. ACCESSIBILITY TO PUBLIC: Exterior visible from public road: Yes ☒ No ☐  
Interior accessible: Explain by appointment

## DESCRIPTION

8. BUILDING MATERIAL: a. clapboard ☒ b. stone ☐ c. brick ☐ d. board and batten ☐  
e. cobblestone ☐ f. shingles ☐ g. stucco ☐ other: \_\_\_\_\_  
9. STRUCTURAL SYSTEM: a. wood frame with interlocking joints ☒  
(if known) b. wood frame with light members ☐  
c. masonry load bearing walls ☐  
d. metal (explain) \_\_\_\_\_  
e. other \_\_\_\_\_  
10. CONDITION: a. excellent ☒ b. good ☐ c. fair ☐ d. deteriorated ☐  
11. INTEGRITY: a. original site ☒ b. moved ☐ if so, when? \_\_\_\_\_  
c. list major alterations and dates (if known): \_\_\_\_\_

12. PHOTO:

13. MAP

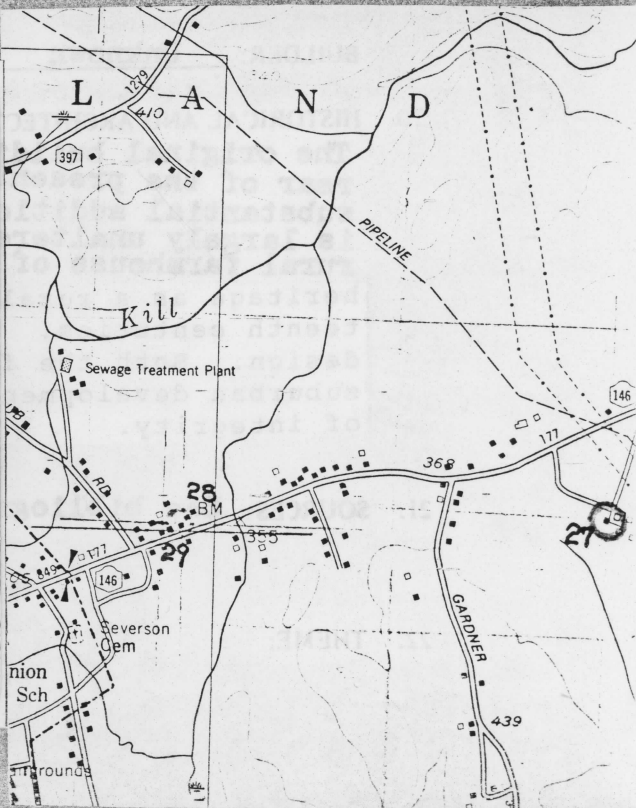

14. THREATS TO BUILDING: a. none known ☒ b. zoning ☐ c. roads ☐  
d. developers ☐ e. deterioration ☐  
f. other: \_\_\_\_\_

15. RELATED OUTBUILDINGS AND PROPERTY:  
a. barn ☒ b. carriage house ☐ c. garage ☐  
d. privy ☐ e. shed ☐ f. greenhouse ☐  
g. shop ☐ h. gardens ☐  
i. landscape features: \_\_\_\_\_  
j. other: \_\_\_\_\_

16. SURROUNDINGS OF THE BUILDING (check more than one if necessary):  
a. open land ☒ b. woodland ☐  
c. scattered buildings ☐  
d. densely built-up ☐ e. commercial ☐  
f. industrial ☐ g. residential ☐  
h. other: Power lines

17. INTERRELATIONSHIP OF BUILDING AND SURROUNDINGS:  
(Indicate if building or structure is in an historic district)  
**Set very far off the road; still retains its original farm setting.**

18. OTHER NOTABLE FEATURES OF BUILDING AND SITE (including interior features if known):  
**Two-story farmhouse, five bays wide with center entrance and gable roof; one-story porch across front extending east to form a porte-cochere; two-story ell on rear; interior remains largely unaltered; evidence of a small 18th-century house on rear.**

SIGNIFICANCE

19. DATE OF INITIAL CONSTRUCTION: ca. 1860 (rear 1790's)

ARCHITECT: Unknown

BUILDER: Unknown

20. HISTORICAL AND ARCHITECTURAL IMPORTANCE:  
**The original building was a small Dutch house located to the rear of the present structure. As the farm grew the substantial addition was constructed in the 1860's. The house is largely unaltered and is an excellent example of restrained rural farmhouse of the 19th century.** It reflects Guilderland's heritage as a rural, agrarian community of the eighteenth and nineteenth centuries. The barn complex is of a notable vernacular design. Both the farmhouse and barns survive amidst contemporary suburban development. The buildings display a significant degree of integrity.

21. SOURCES: **See bibliography**

22. THEME:



4178 Altamont Road

Building #27

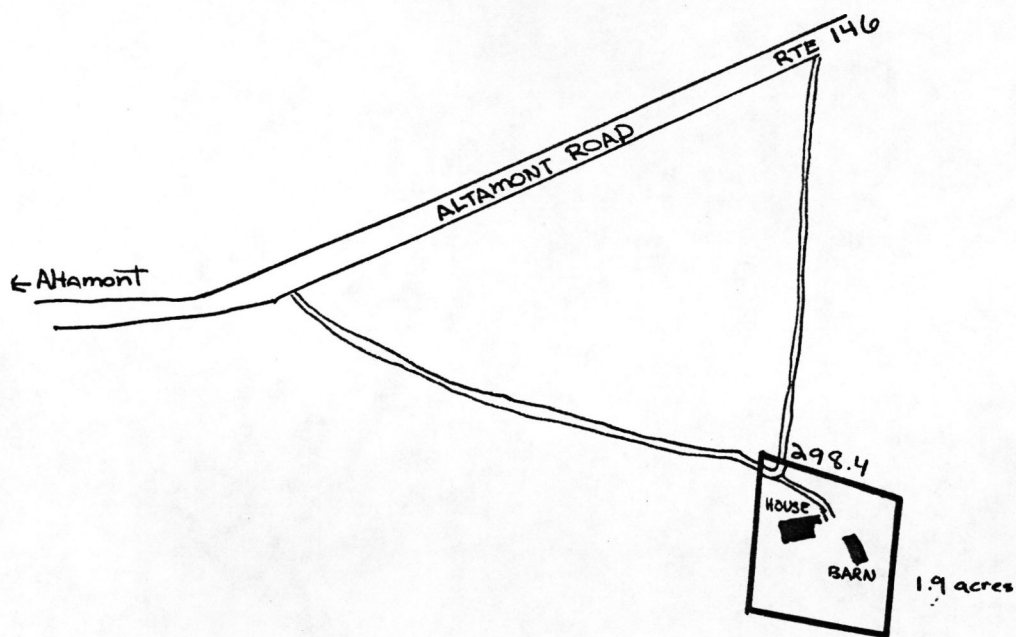

McNiven Farm Complex  
Historic Resources of  
Guilderland Phase I  
Albany County Guilderland  
New York  
Site Map (from tax map)  
Smith & Mahoney 1979

1" = 400'

EXP. 10/31/84

United States Department of the Interior  
National Park ServiceNational Register of Historic Places  
Inventory—Nomination Form

For NPS use only

received

date entered

Continuation sheet

Item number

Page 24

Multiple Resource Area  
Thematic Group

dhr-11

Name Guilderland Multiple Resource Area  
State New York

Nomination/Type of Review

Date/Signature

- |          |  |                                     |            |                       |                 |
|----------|--|-------------------------------------|------------|-----------------------|-----------------|
| ✓ 102 1. | Altamont Historic District               | Entered in the<br>National Register | for Keeper | <u>Delores Byers</u>  | <u>11/10/82</u> |
|          |  |                                     | Attest     |                       |                 |
| 2.       | Apple Tavern                             | Entered in the<br>National Register | for Keeper | <u>Delores Byers</u>  | <u>11/10/82</u> |
|          |  |                                     | Attest     |                       |                 |
| 3.       | Guilderland Cemetery Vault               | Entered in the<br>National Register | for Keeper | <u>Delores Byers</u>  | <u>11/10/82</u> |
|          |  |                                     | Attest     |                       |                 |
| 4.       | McNiven Farm Complex                     | Entered in the<br>National Register | for Keeper | <u>Delores Byers</u>  | <u>11/10/82</u> |
|          |  |                                     | Attest     |                       |                 |
| ✓ 106 5. | Crounse, Jacob, Inn                      | Substantive Review                  | Keeper     | <u>Franklin Dwyer</u> | <u>11/10/82</u> |
|          |  |                                     | Attest     |                       |                 |
| 6.       | Knower House                             | Entered in the<br>National Register | for Keeper | <u>Delores Byers</u>  | <u>11/10/82</u> |
|          |  |                                     | Attest     |                       |                 |
| 7.       | Gardner House                            | Entered in the<br>National Register | for Keeper | <u>Delores Byers</u>  | <u>11/10/82</u> |
|          |  |                                     | Attest     |                       |                 |
| 8.       | Crounse, John and Henry,<br>Farm Complex | Entered in the<br>National Register | for Keeper | <u>Delores Byers</u>  | <u>11/10/82</u> |
|          |  |                                     | Attest     |                       |                 |
| 9.       | Crounse, Frederick, House                | Entered in the<br>National Register | for Keeper | <u>Delores Byers</u>  | <u>11/10/82</u> |
|          |  |                                     | Attest     |                       |                 |
| ✓ 11 10. | Vanderpool Farm Complex                  | Substantive Review                  | Keeper     | <u>Franklin Dwyer</u> | <u>11/10/82</u> |
|          |  |                                     | Attest     |                       |                 |



United States Department of the Interior  
National Park Service

McNiven Farm Complex (Guilderland MRA)  
Albany County  
NEW YORK

Working No. 9/29/82-2682

Fed. Reg. Date: 2.1.83

Date Due: 10/29/82 - 11/3/82

Action: ☒ ACCEPT 11/10/82

☐ RETURN

☐ REJECT

Entered in the  
National Register

Federal Agency: \_\_\_\_\_

- ☐ resubmission  
☐ nomination by person or local government  
☐ owner objection  
☐ appeal

Substantive Review: ☐ sample ☐ request ☐ appeal ☐ NR decision

Reviewer's comments:

Recom./Criteria \_\_\_\_\_

Reviewer \_\_\_\_\_

Discipline \_\_\_\_\_

Date \_\_\_\_\_

☐ see continuation sheet

Nomination returned for: ☐ technical corrections cited below  
☐ substantive reasons discussed below

### 1. Name

### 2. Location

### 3. Classification

Category	Ownership	Status	Present Use
	Public Acquisition	Accessible	

### 4. Owner of Property

### 5. Location of Legal Description

### 6. Representation in Existing Surveys

has this property been determined eligible? ☐ yes ☐ no

### 7. Description

Condition		Check one	Check one
<input type="checkbox"/> excellent	<input type="checkbox"/> deteriorated	<input type="checkbox"/> unaltered	<input type="checkbox"/> original site
<input type="checkbox"/> good	<input type="checkbox"/> ruins	<input type="checkbox"/> altered	<input type="checkbox"/> moved date _____
<input type="checkbox"/> fair	<input type="checkbox"/> unexposed		

Describe the present and original (if known) physical appearance

- ☐ summary paragraph  
☐ completeness  
☐ clarity  
☐ alterations/integrity  
☐ dates  
☐ boundary selection

## **8. Significance**

Period \_\_\_\_\_ Area of Significance—Check and justify below

Specific dates \_\_\_\_\_ Builder/Architect \_\_\_\_\_

Statement of Significance (in one paragraph)

- ☐ summary paragraph
- ☐ completeness
- ☐ clarity
- ☐ applicable criteria
- ☐ justification of areas checked
- ☐ relating significance to the resource
- ☐ context
- ☐ relationship of integrity to significance
- ☐ justification of exception
- ☐ other

## **9. Major Bibliographical References**

## **10. Geographical Data**

Acres of nominated property \_\_\_\_\_

Quadrangle name \_\_\_\_\_

USMT References \_\_\_\_\_

Verbal boundary description and justification \_\_\_\_\_

## **11. Form Prepared By**

## **12. State Historic Preservation Officer Certification**

The evaluated significance of this property within the state is:

☐ national ☐ state ☐ local

State Historic Preservation Officer signature \_\_\_\_\_

Title \_\_\_\_\_

Date \_\_\_\_\_

## **13. Other**

- ☐ Maps
- ☐ Photographs
- ☐ Other

Questions concerning this nomination may be directed to \_\_\_\_\_

Signed \_\_\_\_\_

Date \_\_\_\_\_

Phone: 202 272-3504

Comments for any item may be continued on an attached sheet



Historic Resources of  
Guilderland (Phase I)  
MCNIVEN FARM HOUSE (#27)

The house looking  
south from  
Altamont Road



• MAY • 80

Barns to the east  
of the house



• JUN • 80

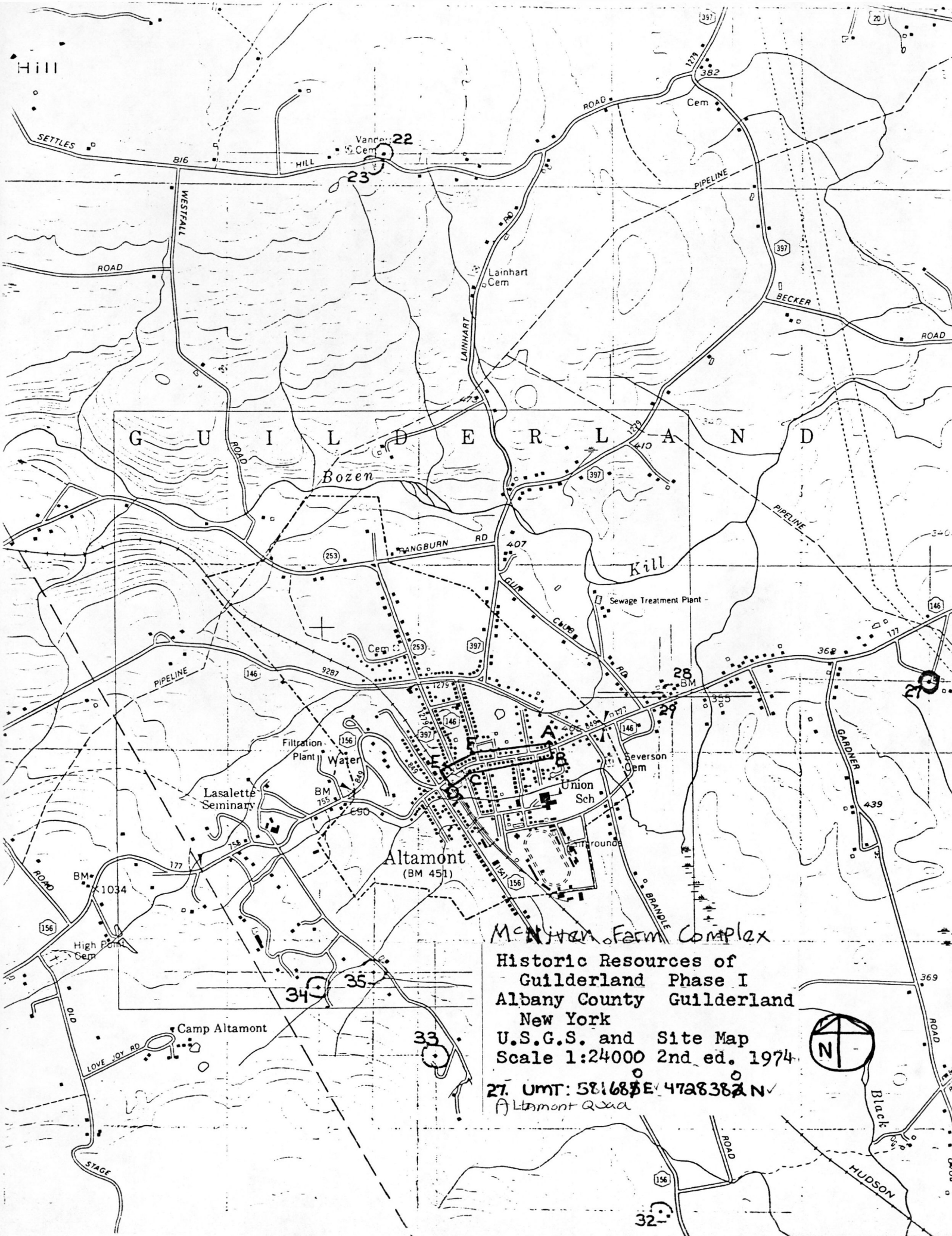

McNiven Farm Complex

Historic Resources of  
Guilderland Phase I  
Albany County Guilderland  
New York

U.S.G.S. and Site Map  
Scale 1:24000 2nd ed. 1974

27. UMT: 581683E 4728382N  
Altamont Quad



Black  
HUDSON