

# BUILDING-STRUCTURE INVENTORY FORM

DIVISION FOR HISTORIC PRESERVATION  
NEW YORK STATE PARKS AND RECREATION  
ALBANY, NEW YORK (518) 474-0479

FOR OFFICE USE ONLY

UNIQUE SITE NO. 001-06-0140  
QUAD \_\_\_\_\_  
SERIES \_\_\_\_\_  
NEG. NO. \_\_\_\_\_

ACCRAGE 101  
JUSTIFIED  
(EADIES)

YOUR NAME: Town of Guilderland DATE: June 1, 1979

YOUR ADDRESS: Town Hall Guilderland TELEPHONE: 518-356-1980  
N.Y.

ORGANIZATION (if any): \_\_\_\_\_

\*\*\*\*\*  
IDENTIFICATION

1. BUILDING NAME(S): Frederick Crounse House (Building #32)
2. COUNTY: Albany TOWN/CITY: Guilderland VILLAGE: \_\_\_\_\_
3. STREET LOCATION: 3960 Altamont-Voorheesville Rd.
4. OWNERSHIP: a. public ☐ b. private ☒
5. PRESENT OWNER: A. G. Gabriels ADDRESS: Box 462 R.D.2, Altamont, N.Y.
6. USE: Original: residence Present: residence 12009
7. ACCESSIBILITY TO PUBLIC: Exterior visible from public road: Yes ☒ No ☐  
Interior accessible: Explain by appointment

## DESCRIPTION

8. BUILDING MATERIAL: a. clapboard ☒ b. stone ☐ c. brick ☐ d. board and batten ☐  
e. cobblestone ☐ f. shingles ☐ g. stucco ☐ other: \_\_\_\_\_
9. STRUCTURAL SYSTEM: a. wood frame with interlocking joints ☒  
(if known) b. wood frame with light members ☐  
c. masonry load bearing walls ☐  
d. metal (explain) \_\_\_\_\_  
e. other \_\_\_\_\_
10. CONDITION: a. excellent ☐ b. good ☒ c. fair ☐ d. deteriorated ☐
11. INTEGRITY: a. original site ☒ b. moved ☐ if so, when? \_\_\_\_\_  
c. list major alterations and dates (if known): \_\_\_\_\_

12. PHOTO:

13. MA

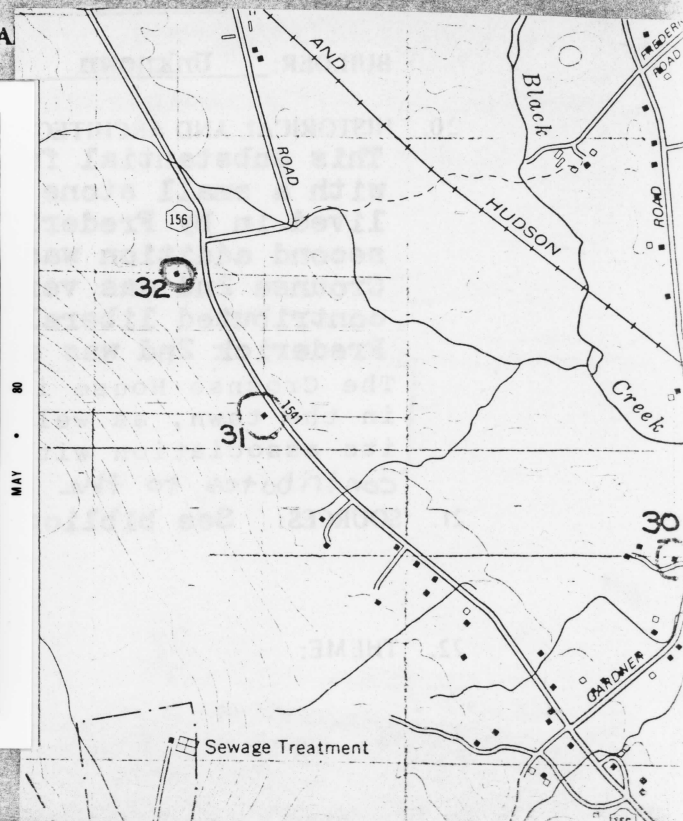

14. THREATS TO BUILDING: a. none known ☒ b. zoning ☐ c. roads ☐  
d. developers ☐ e. deterioration ☐  
f. other: \_\_\_\_\_
15. RELATED OUTBUILDINGS AND PROPERTY:  
a. barn ☒ b. carriage house ☐ c. garage ☒ (not historic)  
d. privy ☐ e. shed ☐ f. greenhouse ☐  
g. shop ☐ h. gardens ☐  
i. landscape features: \_\_\_\_\_  
j. other: \_\_\_\_\_
16. SURROUNDINGS OF THE BUILDING (check more than one if necessary):  
a. open land ☒ b. woodland ☒  
c. scattered buildings ☐  
d. densely built-up ☐ e. commercial ☐  
f. industrial ☐ g. residential ☐  
h. other: small pond

17. INTERRELATIONSHIP OF BUILDING AND SURROUNDINGS:

(Indicate if building or structure is in an historic district)

**Set back from road, it retains its 18th-century setting. Another Crounse house is located to south. Since the original farm is now mostly woodland, the nominated area is an arbitrary 8 acres surrounding the house.**

18. OTHER NOTABLE FEATURES OF BUILDING AND SITE (including interior features if known):

**There is evidence in the farmhouse of the evolution of three separate structures. A small Dutch stone house is at the rear, and a late 18th-century wing was added to that. The main house was built around 1802 and retains much of the original detail in the stairs, mantelpieces and woodwork.**

SIGNIFICANCE

19. DATE OF INITIAL CONSTRUCTION: ca. 1760, ca. 1780, ca. 1802

ARCHITECT: Unknown

BUILDER: Unknown

20. HISTORICAL AND ARCHITECTURAL IMPORTANCE:

**This substantial farmhouse was built in three stages beginning with a small stone Dutch house built around 1760. The house was lived in by Frederick Crounse and records seem to indicate the second addition was added by his son Frederick 2nd. Frederick Crounse 2nd was very patriotic during the Revolutionary War and contributed liberally toward the support of the American cause. Frederick 2nd was also believed responsible for the 1802 addition.**

**The Crounse House is significant as one of the earliest structures in the town, as well as for its Federal period additions and for its association with a notable community figure. Its early barn contributes to the character of the farmhouse.**

21. SOURCES: **See bibliography**

22. THEME:



3960 Altamont-Voorheesville Rd.

Building # 32

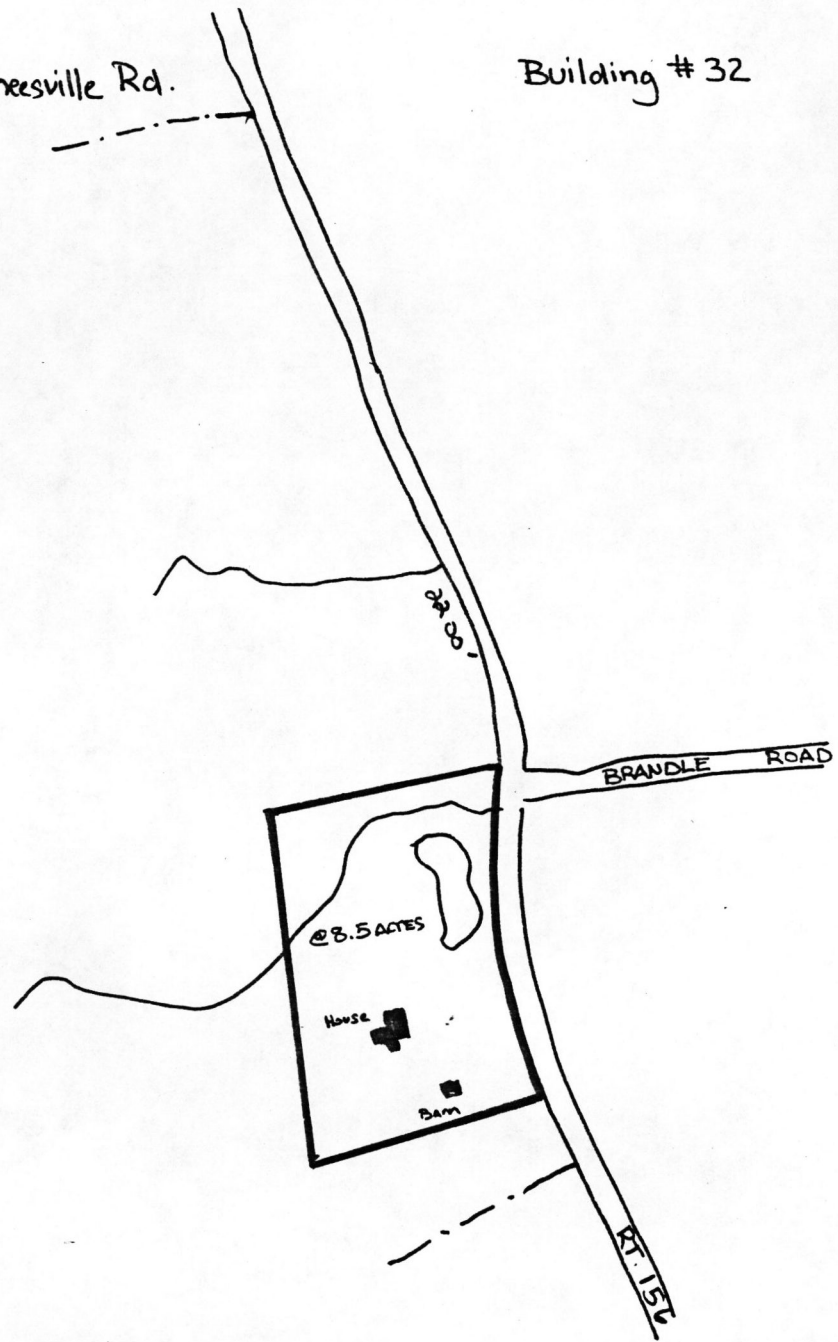

Frederick Crouse House

Historic Resources of  
Guilderland Phase I  
Albany County - Guilderland  
New York  
Site Map (from tax map)  
Smith & Mahoney 1979

N ↑

1" = 400'

EXP. 10/31/84

United States Department of the Interior  
National Park ServiceNational Register of Historic Places  
Inventory—Nomination Form

For NPS use only

received

date entered

Continuation sheet

Item number

Page 4 of 4

Multiple Resource Area  
Thematic Group

dnr-11

Name Guilderland Multiple Resource Area  
State New York

Nomination/Type of Review

Date/Signature

- |     |  |                                     |               |                               |
|-----|--|-------------------------------------|---------------|-------------------------------|
| 1.  | Altamont Historic District               | Entered in the<br>National Register | for<br>Keeper | <u>Delores Byers</u> 11/10/82 |
|     |  |                                     | Attest        | _____                         |
| 2.  | Apple Tavern                             | Entered in the<br>National Register | for<br>Keeper | <u>Delores Byers</u> 11/10/82 |
|     |  |                                     | Attest        | _____                         |
| 3.  | Guilderland Cemetery Vault               | Entered in the<br>National Register | for<br>Keeper | <u>Delores Byers</u> 11/10/82 |
|     |  |                                     | Attest        | _____                         |
| 4.  | McNiven Farm Complex                     | Entered in the<br>National Register | for<br>Keeper | <u>Delores Byers</u> 11/10/82 |
|     |  |                                     | Attest        | _____                         |
| 5.  | Crounse, Jacob, Inn                      | Substantive Review                  | Keeper        | <u>Ann M. Dwyer</u> 11/10/82  |
|     |  |                                     | Attest        | _____                         |
| 6.  | Knower House                             | Entered in the<br>National Register | for<br>Keeper | <u>Delores Byers</u> 11/10/82 |
|     |  |                                     | Attest        | _____                         |
| 7.  | Gardner House                            | Entered in the<br>National Register | for<br>Keeper | <u>Delores Byers</u> 11/10/82 |
|     |  |                                     | Attest        | _____                         |
| 8.  | Crounse, John and Henry,<br>Farm Complex | Entered in the<br>National Register | for<br>Keeper | <u>Delores Byers</u> 11/10/82 |
|     |  |                                     | Attest        | _____                         |
| 9.  | Crounse, Frederick, House                | Entered in the<br>National Register | for<br>Keeper | <u>Delores Byers</u> 11/10/82 |
|     |  |                                     | Attest        | _____                         |
| 10. | Vanderpool Farm Complex                  | Substantive Review                  | Keeper        | <u>Ann M. Dwyer</u> 11/10/82  |
|     |  |                                     | Attest        | _____                         |



United States Department of the Interior  
National Park Service

Crounse, Frederick, House (Guilderland MRA)  
Albany County  
NEW YORK

Working No. 9/29/82-2692

Fed. Reg. Date: 2.1.83

Date Due: 10/29/82 - 11/13/82

Action: ☒ ACCEPT 11/10/82

Entered in the ☐ RETURN

National Register ☐ REJECT

Federal Agency: \_\_\_\_\_

- ☐ resubmission  
☐ nomination by person or local government  
☐ owner objection  
☐ appeal

Substantive Review: ☐ sample ☐ request ☐ appeal ☐ NR decision

Reviewer's comments:

Recom./Criteria \_\_\_\_\_

Reviewer \_\_\_\_\_

Discipline \_\_\_\_\_

Date \_\_\_\_\_

see continuation sheet

Nomination returned for: ☐ technical corrections cited below  
☐ substantive reasons discussed below

1. Name

2. Location

3. Classification

Category	Ownership	Status	Present Use
	Public Acquisition	Accessible	

4. Owner of Property

5. Location of Legal Description

6. Representation in Existing Surveys

has this property been determined eligible? ☐ yes ☐ no

7. Description

Condition	Check one	Check one
<input type="checkbox"/> excellent	<input type="checkbox"/> deteriorated	<input type="checkbox"/> original site
<input type="checkbox"/> good	<input type="checkbox"/> ruins	<input type="checkbox"/> moved date _____
<input type="checkbox"/> fair	<input type="checkbox"/> unexposed	

Describe the present and original (if known) physical appearance

- ☐ summary paragraph  
☐ completeness  
☐ clarity  
☐ alterations/integrity  
☐ dates  
☐ boundary selection

## **8. Significance**

Period \_\_\_\_\_ Areas of Significance—Check and justify below

Specific dates \_\_\_\_\_ Builder/Architect \_\_\_\_\_

Statement of Significance (in one paragraph)

- \_\_\_\_\_ summary paragraph
- \_\_\_\_\_ completeness
- \_\_\_\_\_ clarity
- \_\_\_\_\_ applicable criteria
- \_\_\_\_\_ justification of areas checked
- \_\_\_\_\_ relating significance to the resource
- \_\_\_\_\_ context
- \_\_\_\_\_ relationship of integrity to significance
- \_\_\_\_\_ justification of exception
- \_\_\_\_\_ other

## **9. Major Bibliographical References**

## **10. Geographical Data**

Acreage of nominated property \_\_\_\_\_

Quadrangle name \_\_\_\_\_

UNIT References

Verbal boundary description and justification

## **11. Form Prepared By**

## **12. State Historic Preservation Officer Certification**

The evaluated significance of this property within the state is:

\_\_\_\_\_ national \_\_\_\_\_ state \_\_\_\_\_ local

State Historic Preservation Officer signature

Title \_\_\_\_\_ date \_\_\_\_\_

## **13. Other**

- \_\_\_\_\_ Maps
- \_\_\_\_\_ Photographs
- \_\_\_\_\_ Other

Questions concerning this nomination may be directed to \_\_\_\_\_

Signed \_\_\_\_\_ Date \_\_\_\_\_ Phone: 202 272-3504

Comments for any item may be continued on an attached sheet



Historic Resources of  
Guilderland (Phase I)  
Guilderland, New York  
Albany County

FREDERICK CROUNSE HOUSE  
BUILDING #32

Barns & garages  
southeast of property



MAY • 80

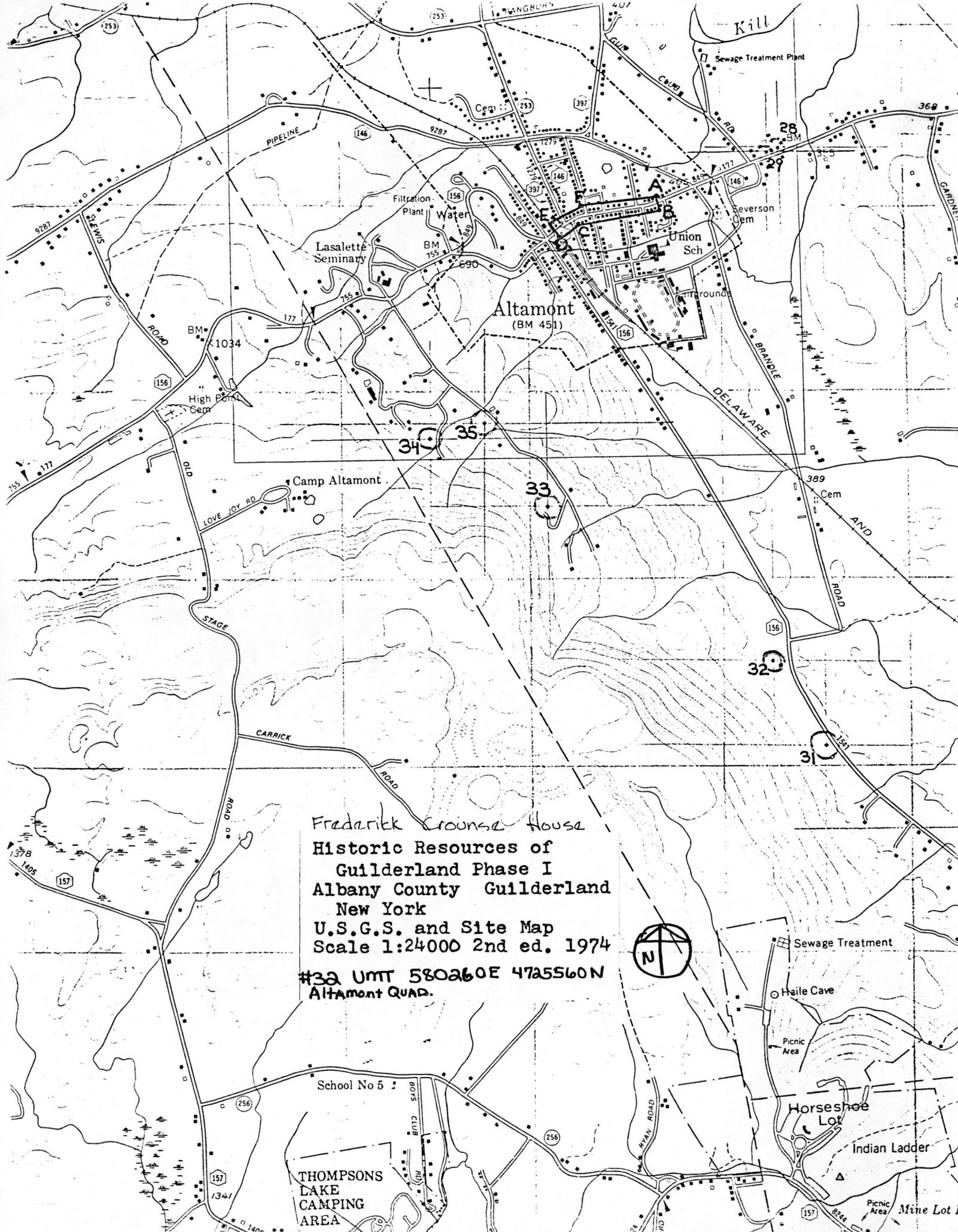

Frederick Crouse House  
Historic Resources of  
Guilderland Phase I  
Albany County Guilderland  
New York  
U.S.G.S. and Site Map  
Scale 1:24000 2nd ed. 1974  
#32 UMT 580260E 4725560N  
Altamont Quad.

